

# ***Penny+Giles***

**A Curtiss-Wright Company**

<b>TYPE:</b>	<b>RCP 18/2S</b>
<b>SPECIFICATION:</b>	<b>D150473</b>
<b>ISSUE:</b>	<b>1</b>
<b>DATE:</b>	<b>02/04/2003</b>

## **(C) PENNY & GILES CONTROLS LTD**

This document and any other information contained therein are confidential and the copyright of Penny & Giles Controls Limited. Without infringement neither the whole nor any extract may be disclosed, loaned, copied or used for manufacturing or any other purpose whatsoever without their prior written consent and no liability is accepted for loss or damage from any cause whatsoever from the use of this document.

**Penny & Giles Controls Ltd.,** Units 35/36 Nine Mile Point Ind. Est., Cwmlinfach, NP11 7HZ, UK  
Tel: +44 (0)1495 202000 Fax: +44 (0)1495 202006 [www.pennyandgiles.com](http://www.pennyandgiles.com)

Registered Office: 1 Airfield Road, Christchurch, Dorset, BH23 3TH, United Kingdom  
Registered In England No. 843903 VAT Registration No. 682 4436 21

## **CONTENTS**

1.	<b>Description</b>	<b>Page 3</b>
2.	<b>Tabulated Data: Electrical</b>	<b>Page 3</b>
3.	<b>Installation Diagram</b>	<b>Page 4</b>
4.	<b>Tabulated Data: Mechanical</b>	<b>Page 4</b>
5.	<b>Tabulated Data: Environmental</b>	<b>Page 5</b>
6.	<b>Labelling Instruction</b>	<b>Page 5</b>
7.	<b>Packing Instruction</b>	<b>Page 5</b>
8.	<b>Records of Revision</b>	<b>Page 6</b>

1. **DESCRIPTION**

Rotary Conductive Plastic Potentiometer Type RCP 18/2S.

2. **TABULATED DATA: ELECTRICAL**

Resistance	02k ohms $\pm 10\%$
Electrical Angle	$352^\circ \pm 1^\circ$
Linearity (Independent)	$\pm 0.50\%$ (Over each half, excluding taps)
Resolution	Virtually Infinite
Power Dissipation	3 watts @ $20^\circ\text{C}$
Insulation	100 M ohms min. at 500Vdc.
Output smoothness	MIL-R-39023 grade C 0.1%

**CIRCUIT DIAGRAM**

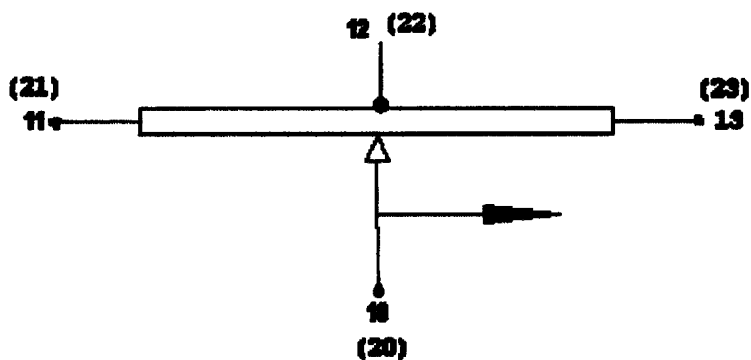

### 3 INSTALLATION DIAGRAM

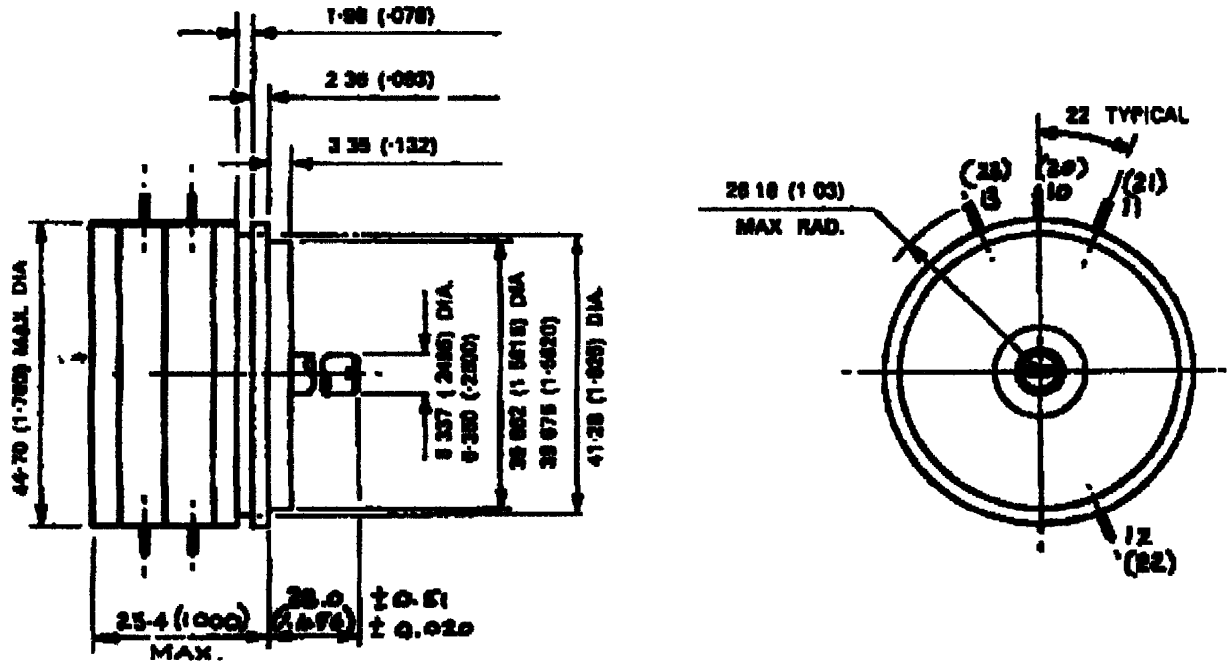

All dimensions in millimetres, General tolerance  $\pm 0.127\text{mm}$

### 4 TABULATED DATA: MECHANICAL

Mechanical Angle	360° Continuous rotation.
Starting Torque	24gm cm max.
Shaft Run Out	0.001 inches TIR
Lateral Run Out	0.002 inches TIR
Pilot Run Out	0.001 inches TIR
Shaft End Play	0.0005 inches max.

**5. TABULATED DATA: ENVIRONMENTAL**

Temperature Range -65°C to +130°C

**6. LABELLING INSTRUCTION**

Rear of unit to be marked:

Penny & Giles Specification D150473 Current issue status .....

Serial No:.....

**7. PACKING INSTRUCTION**

Each unit is to be enclosed in a polythene bag and packed in a container.

**NOTE: Warning label ND37717 to be enclosed.**

**8. RECORDS OF REVISION**

Specification prepared by: 

Date: 02/04/2003

Approved by: 

Engineering Authority Date: 14.4.03

Approved by: 

Quality Manager Date: 26/04/03

**Revisions      Change Note No      Prepared      Approved      Quality      Date**